

WHEEL - A - THON WEEK 2021

The Wheel-A-Thon committee, PACE, the faculty and staff of St. Agnes have teamed up once again to create a fun day/week for all!

INSIDE YOU WILL FIND

- General information
- Bicycle drop-off map
- Dates to remember
- Riding Times
- Prizes!!!
- Pledge Sheets
- Permission Slip
- Non Participation Form

IMPORTANT!!!!

***DO NOT TURN IN PLEDGE SHEETS BEFORE WAT, THEY ARE DUE AT THE SAME TIME AS PLEDGE MONEY IS TURNED IN**

THERE WILL BE

- Free Dress for all students
- Snack and drinks for students after they ride

This packet is full of important information. Please read it through carefully and mark your calendars.

Please note all students will be dismissed at noon due to minimum day schedule

Wheel-A-Thon

2021

WHEN IS WHEEL-A-THON

Our annual Wheel-A-Thon will be held on Thursday, September 23, 2021. This is a half day and students will be dismissed at noon.

WHAT IS THE PURPOSE

Wheel-A-Thon is one of St. Agnes School's greatest fundraising efforts of the year! It is the **ONLY** event that raises money to finance educational field trips. Examples of previous field trips include: Caritas Creek Camp (5th) Monte Toyon (3rd), NASA facilities, Fort Ross, California Missions, Marine Mammal Center of Marin, The State Capital, Walnut Creek Performing Arts Center, and various cultural events.

WHO BENEFITS

The *STUDENTS* of St. Agnes School benefit directly and proportionally from the funds they raise. The money raised by each student is used for his/her own class to pay for field trips.

HOW DO WE CONTRIBUTE

Students are encouraged to seek contributions for the number of bicycle laps they ride during the Wheel-A-Thon. Contributors promise to make a tax-deductible donation per lap which the students collect after the event, or, if they prefer, contributors may make a donation in a pre-determined amount regardless of the number of laps. Be sure to check with your workplace since many offer matching contributions!

INCENTIVES & PRIZES

We have many fine prizes to offer as incentives to students and classes to encourage enthusiastic participation and efforts.

Wheel-A-Thon Drop-Off / Pick-Up Routes

Morning Drop-Off: Follow the path of the \longrightarrow arrow lines - volunteers will guide you.

Afternoon Pick-Up: Follow the path of the \dashrightarrow arrow lines - volunteers will guide you.

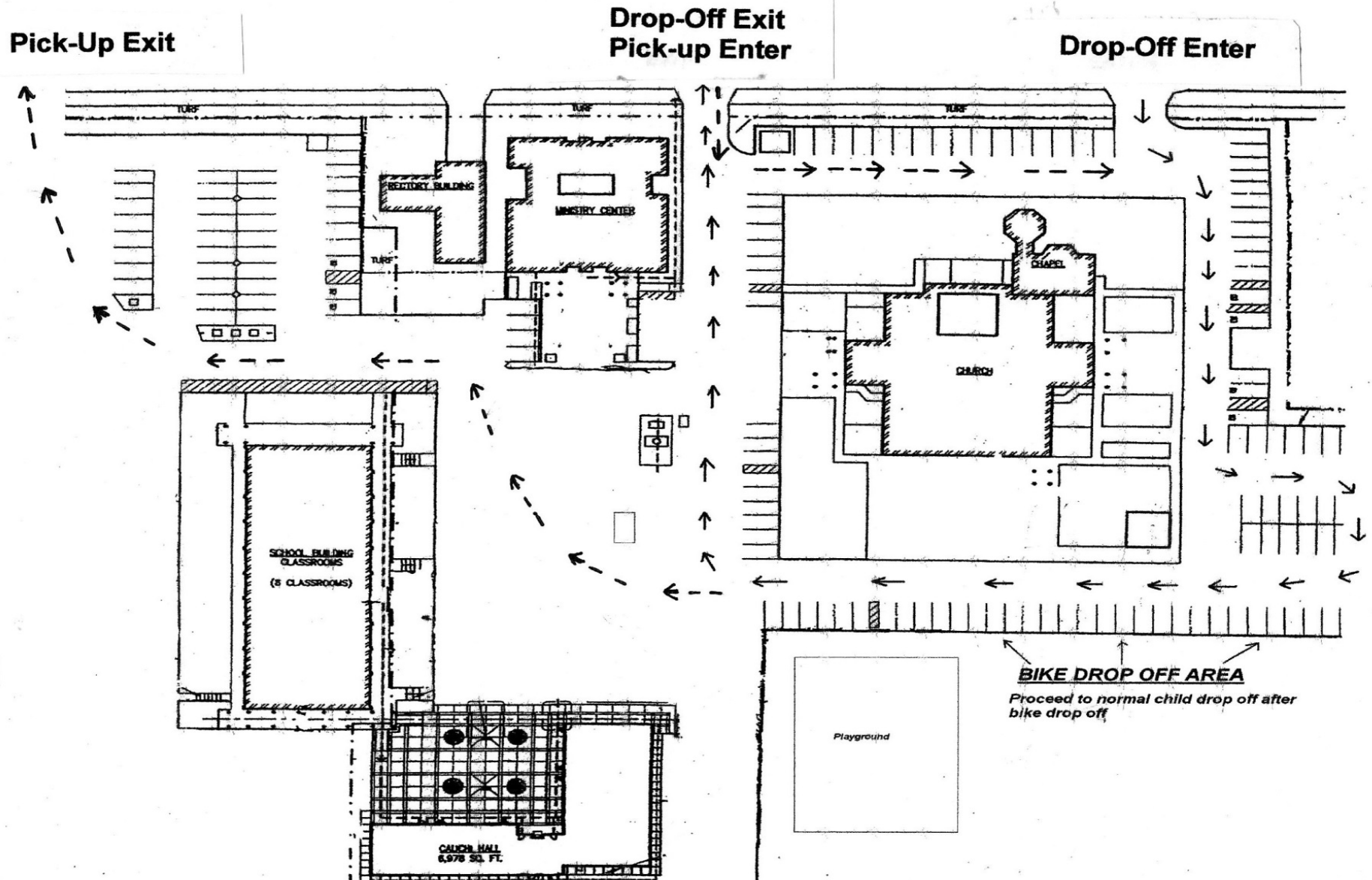

Dates to Remember

Wednesday	9/15	Wheel-A-Thon packets go home
Monday	9/20	\$5.00 fee per child due All Permission slips due
Thursday	9/23	WHEEL-A-THON DAY!!!
Friday	10/08	Final due date for pledge sheets and all pledge \$\$\$
Friday	10/28	<i>Awards Assembly</i>

We must receive 100% of pledged money on or before 10/08 by end of school day (3:00) in order for students to be eligible to receive prizes at Awards Assembly.

Wheel-A-Thon

2021

Grade	Track	Start Time	Finish Time
K	Small	8:35	8:55
K	T	8:35	8:55
1	Small	9:00	9:20
1	T	9:00	9:20
2	Small	9:35	9:55
2	T	9:35	9:55
3	Large	8:15	8:35
4	Large	8:40	9:00
5	Large	9:05	9:30
6	Large	9:35	10:00
7	Large	10:05	10:30
8	Large	10:35	11:00

IMPORTANT NOTES:

- Rider name must be placed on bike, so it can be clearly seen **before** they are brought to school.
- ALL bikes must be **walked** to and from track area!
- Every rider must wear a **helmet!**
- T-Track is available to those children in Kinder, 1st, and 2nd grade who ride bikes with training wheels. **No “Big Wheels” or scooters allowed.**
- As a safety precaution for all students, please make sure your child is proficient at riding the bike they bring to participate in the Wheel-A-Thon.
- **All children must have a parent or guardian’s signature on the permission form to ride in the Wheel-a-thon. We can NOT allow anyone without a signature to ride, due to liability concerns.**

PRIZE LIST

**NEW PRIZES FOR THE 2021 WAT
WILL BE COMING OUT SOON!!!**

Top Participation - Pizza and Ice Cream party

Class with the most participation (riders and students who receive donations)

1st Place Class with highest donation amount - Ice Cream Party and \$150 towards class fund

2nd Place Class with highest donation amount - Ice Cream Party and \$100 towards class fund

3rd Place Class with highest donation amount - Ice Cream Party and \$50 towards class fund

St. Agnes School · Wheel-A-Thon Pledge

Student Name: _____

Grade : _____

SAFTY FIRST!!! Adults should accompany students soliciting donations.
Please only use black or blue ink

						FOR OFFICE USE ONLY	
Sponsor's Name	Home Address	Flat pledge	Amount Due			Check Number	Cash
1.							
2.							
3.							
4.							
5.							
6.							
7.							
8.							
9.							
SUBTOTAL FRONT							
SUBTOTAL BACK							
GRAND TOTAL							

FOR OFFICE USE ONLY - DO NOT WRITE IN BOX	VERIFICATION BY: _____
NUMBER OF LAPS COMPLETED : _____ CASH \$ _____	
TOTAL AMOUNT PLEDGED \$ _____ CHECK \$ _____	
	TOTAL AMOUNT PAID \$ _____

						FOR OFFICE USE ONLY	
Sponsor's Name	Home Address	Flat Pledge	Amount Due			Check Number	Cash
1.							
2.							
3.							
4.							
5.							
6.							
7.							
8.							
9.							
10.							
11.							
12.							
13.							
14.							
15.							
16.							
SUBTOTAL BACK							

ST. AGNES SCHOOL WHEEL-A-THON
PARENT PERMISSION FORM

DUE
9/20

(FAMILY NAME)

To the Principal of St. Agnes School:

I hereby request that my son(s)/daughter(s),

Child's Name	Child's Grade

be able to participate in the **St. Agnes School Wheel-A-Thon**, to be held on **September 23, 2021**.

I agree to direct my child to cooperate and conform to directions and instructions of the supervisory personnel in charge of this event.

I understand that any expenses incurred for medical treatment of my child will be first submitted to my personal medical/dental insurance plans. Unpaid benefits can be submitted to Myers-Stevens as a secondary provider.

CONSENT FOR TREATMENT

(I), the undersigned parent or legal guardian of a minor, do hereby authorize a representative of **St. Agnes School** as agent(s) for the undersigned to consent to any x-ray examination, anesthetic, medical or surgical diagnosis or treatment and hospital care that is deemed advisable by, and is to be rendered under the general or special supervision of any physician or surgeon licensed under the provision of the California Medical Practice Act, on the medical staff or an accredited hospital, whether such diagnosis or treatment is rendered at the office of said physician or at said hospital.

It is understood that this authorization is given in advance of any specific diagnosis, treatment or hospital care being required but is given to provide authority and power on the part of the above mentioned agent(s) to give specific consent to any and all such diagnosis, treatment or hospital care that the above mentioned physician in the exercise of his or her best judgment may deem advisable.

Parent/Guardian Signature _____ Date _____

Parent Name (Print)

Emergency phone number

NON PARTICIPATION FORM

My child/children **will not** be riding in the 2018 St. Agnes Wheel-A-Thon on THURSDAY, September 23.

Child's Name	Child's Grade