



# WHEEL-A-THON

*Please read through carefully and mark your calendars*

## *Important Dates*

**9/10** \$5 participation form & permission slips due

**9/26** WAT Day

**10/17** Final due date for pledges

**10/31** Award Assembly

## *Pledge Website*

**Be on the look out for an email from Pledge Star!!**

**Meg Driscoll  
Tara Lynch**

p. 925.360.0530

e. [SAwheelathon@gmail.com](mailto:SAwheelathon@gmail.com)



## What is Wheel-A-Thon

Wheel-A-Thon is one of St. Agnes School's greatest fundraising efforts of the year! It is the ONLY event that raises money to finance educational field trips. Examples of previous field trips include: Caritas Creek Camp (5th) Monte Toyon (3rd), NASA facilities, Fort Ross, California Missions, Marine Mammal Center of Marin, The State Capital, Walnut Creek Performing Arts Center, and various cultural events.

## How to contribute

Students are encouraged to seek contributions for them riding during the Wheel-A-Thon. Contributors promise to make a tax-deductible donation which they can donate using the Pledge Star link that will be emailed to you. Be sure to check with your workplace since many offer matching contributions!



# 2025 WAT PRIZES

## Top donation brought in by a student per class

- PK
  - Musical Balance Stepping Stones
- Kinder
  - Outdoor Toss Game
- First
  - Outdoor Ring Toss
- Second
  - Backyard Golf
- Third
  - Giant Outdoor Jenga
- Fourth
  - Giant Outdoor Dice
- Fifth
  - Slammo
- Sixth, Seventh & Eighth
  - Badminton Set

## Paddle Board

\*any student who brings in over \$200 in donations will be placed in a raffle, ticket will be drawn at Award assembly

### Top Class Participation

- Class Trophy
- Pizza and Ice Cream party
  - Class with the most participation (riders and students who receive donations, donation amount does not count)

### 1st Place Class with highest donation amount

- Ice Cream Party and Free Dress Pass

### 2nd Place Class with highest donation amount

- Ice Cream Party

### 3rd Place Class with highest donation amount

- Ice Cream Party

## RIDER TIMES

PK	9:55
K	8:20
1	8:45
2	9:20
3	8:30
4	8:30
5	9:20
6	9:20
7	10:10
8	10:10



## IMPORTANT NOTES

- Participation fee of \$5 per rider
- Rider name must be placed on bike, so it can be clearly seen before they are brought to school. (Use tape or a label to write name on bike & helmet)
- During drop off, parents & kids stay in car while volunteers unload bikes
- During pick up, bikes will be loaded into vehicles and then cars will move into regular carline
- Every rider must wear a helmet!
- There are two tracks available to those children in Kinder through 2nd grade, a T-Track for those who ride bikes with training wheels, and a Small track for those on two wheels. No "Big Wheels", striders or scooters allowed.
- 3rd - 8th grade will have one track available to those who ride. Only two wheel bikes allowed (no striders)
- As a safety precaution for all students, please make sure your child is proficient at riding the bike they bring to participating
- All children must have a parent or guardian's signature on the permission form to ride
- We can NOT allow anyone without a signature to ride, due to liability concerns.
- Pre-School children will walk the track and not ride, pick up and drop off will be at the flagpole

# 



- Morning Drop-Off: Follow the path of the ———→ arrow lines - volunteers will guide you.
- Afternoon Pick-Up: Follow the path of the - - - - -→ arrow lines - volunteers will guide you.

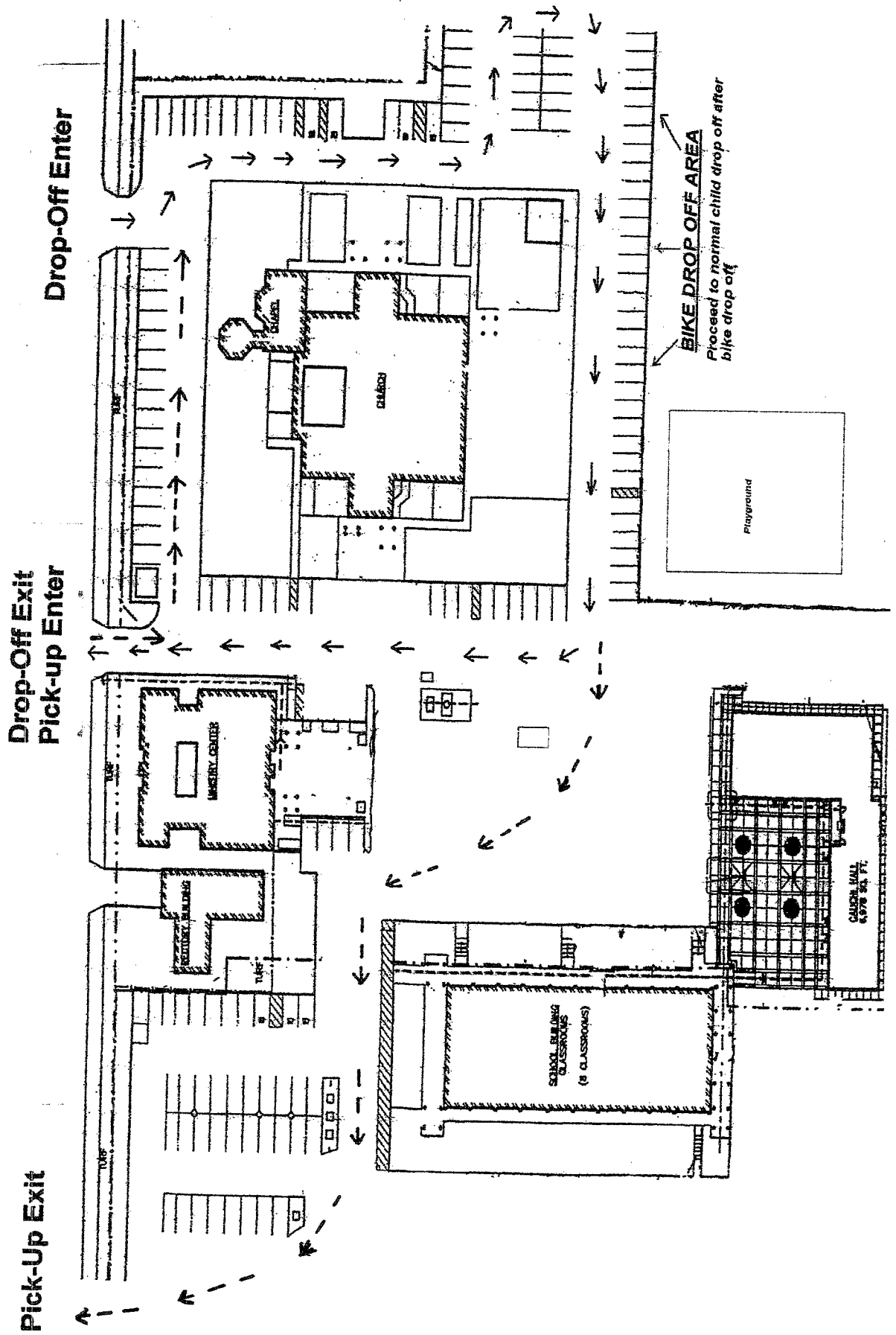



# ST AGNES CATHOLIC SCHOOL

## WHEEL-A-THON RIDER TIMES

### START TIMES

### ENDING TIMES

PK	24	PK	9:55	PK	10:00
K	25	K	8:20	K	8:40
1	30	1	8:45	1	9:15
2	32	2	9:20	2	9:50
3	29	3	8:30	3	9:15
4	32	4	8:30	4	9:15
5	34	5	9:20	5	10:05
6	21	6	9:20	6	10:05
7	35	7	10:10	7	11:00
8	23	8	10:10	8	11:00